

16.5m Articulated HGV - Leaving Site

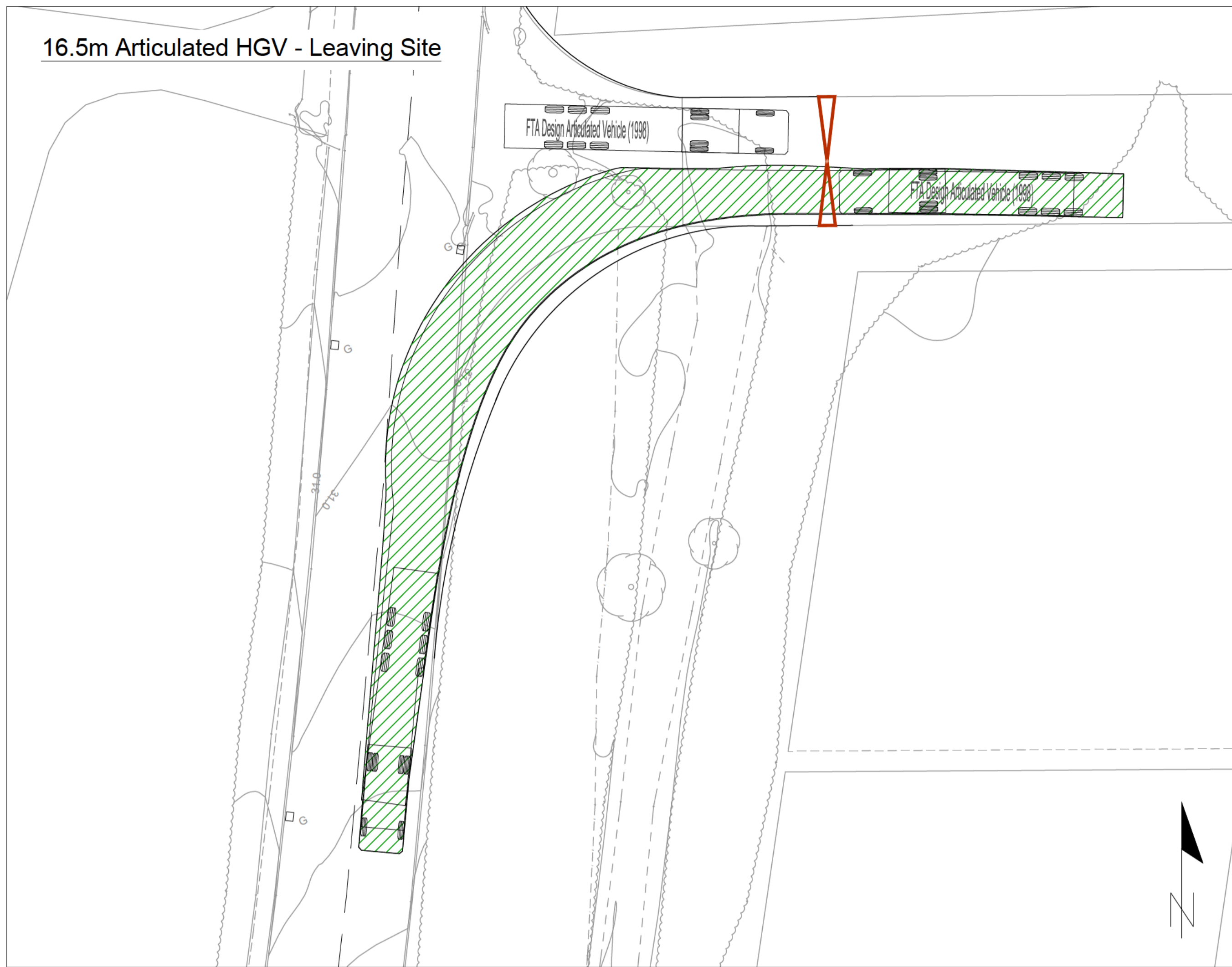

16.5m Articulated HGV - Entering Site

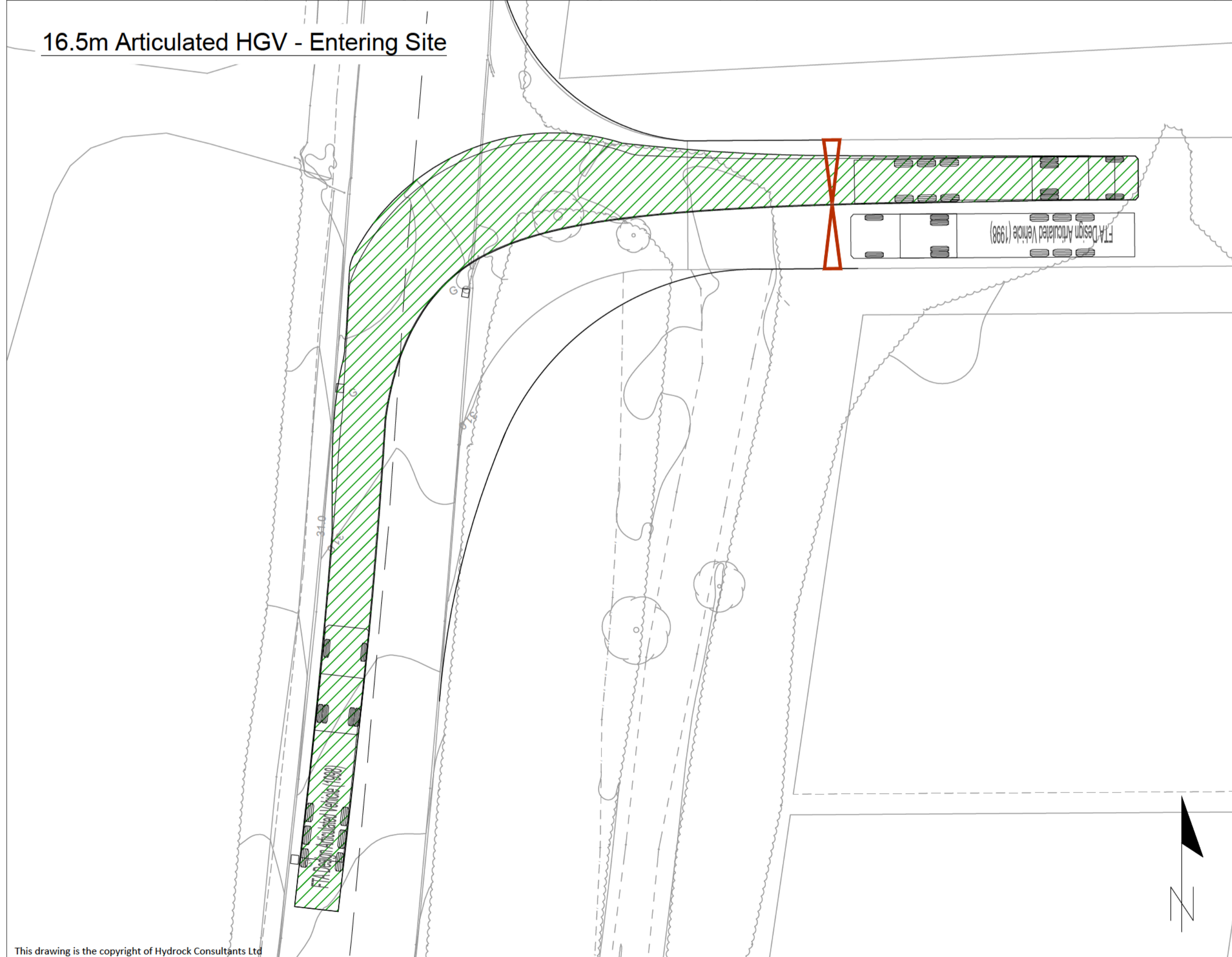

General Arrangement

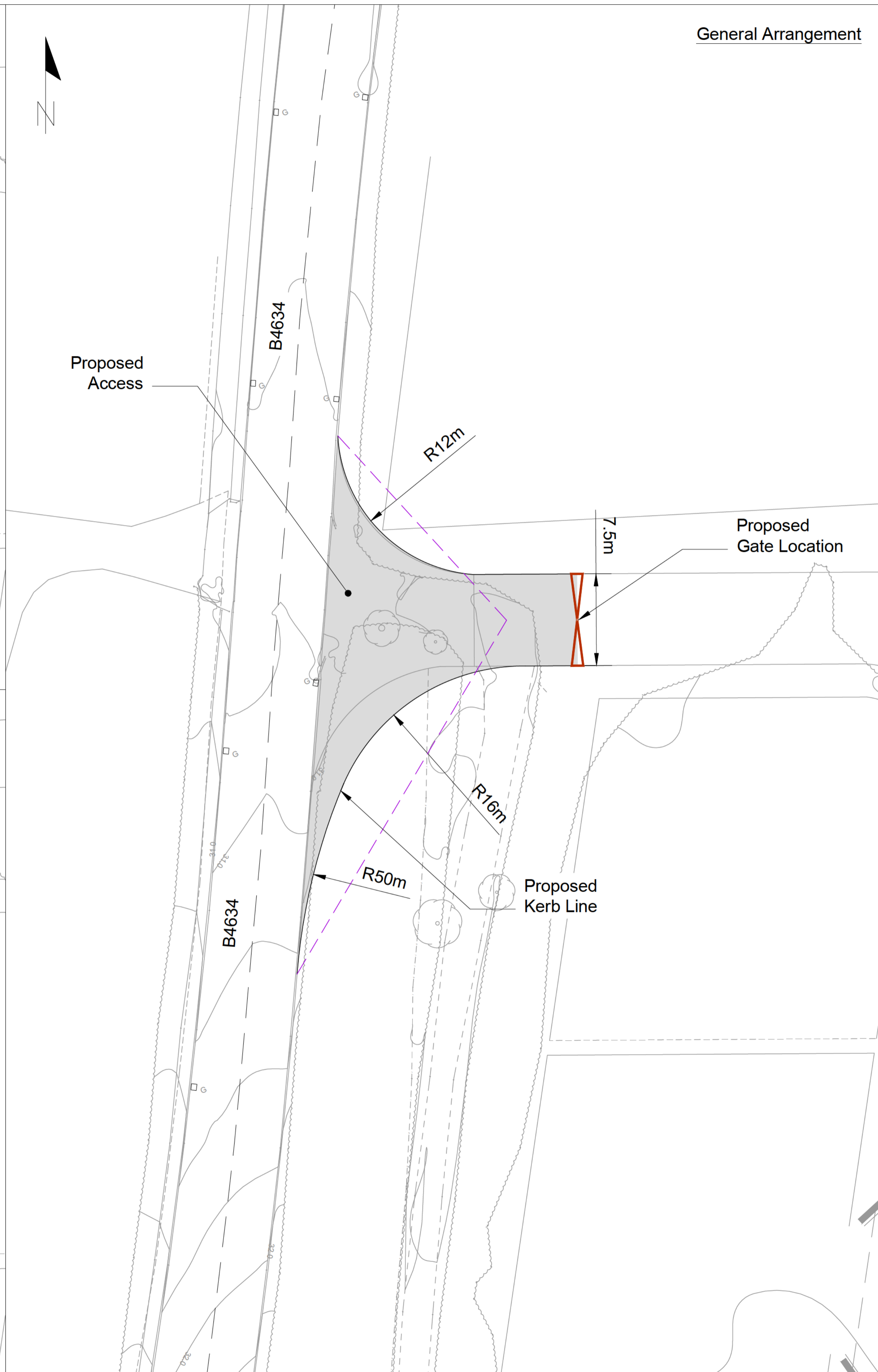

- Notes:**
- All dimensions are to be checked on site before the commencement of works. Any discrepancies are to be reported to the Architect & Engineer for verification. Figured dimensions only are to be taken from this drawing.
 - This drawing is to be read in conjunction with all relevant Engineers' and Service Engineers' drawings and specifications.

Key:

- Visibility Splay 15m
- New carriageway construction

Vehicular track (FTA Design Articulated Vehicle 1998)

- Overall length 16.480m
- Overall width 2.550m
- Overall body height 3.870m
- Min. body ground clearance 0.515m
- Max. track width 2.470m
- Lock to lock time 3.00s
- Kerb to kerb turning radius 6.550m

FTA Design Articulated Vehicle (1998)

Rev	Date	Description	By	Ckd
P1	23.01.2019	First Issue	TF	AC

Architect:
TDA Landscape Design

Hydrock Hydrock Consultants Ltd
 239 Ashley Road
 Hale, Cheshire
 WA15 9NE
 T +44 (0)161 233 0746
 www.hydrock.com

Client:
[Redacted]

Project Title:
Proposed Showman's Site on land off Old Gloucester Road

Drawing Title:
Site Access General Arrangement

Drawing Status:
PLANNING

Hydrock Job No.: **C11553**

Drawn	Checked	Scale @ A1	Date	Issue Date
TF	AC	1:200	21.01.2019	23.01.2019

Drawing Number	Revision
11553-HYD-02-XX-SK-S-001	P1